

TYBOX 117-137

Návod na obsluhu

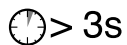

Stlačte tlačítko na min. 3 sekúnd



Teplota v miestnosti

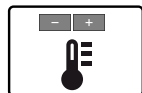

Teplota nastavená užívateľom

PROG
x1

Denné programovanie

PROG
x7

Týždenné programovanie



Technické parametre **A**

AUTO

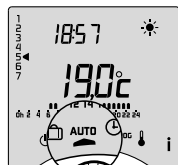

TYBOX - výber programovania

i Informačné tlačítko

Aktuálna teplota v miestnosti

Počet prevádzkových hodín kotla

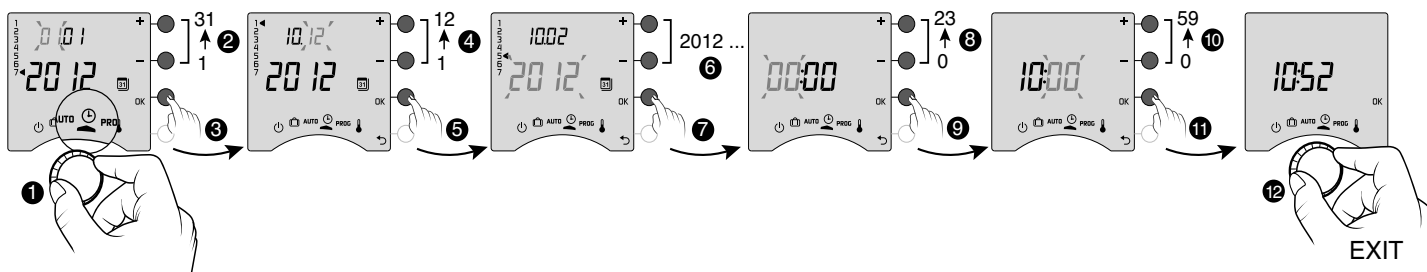
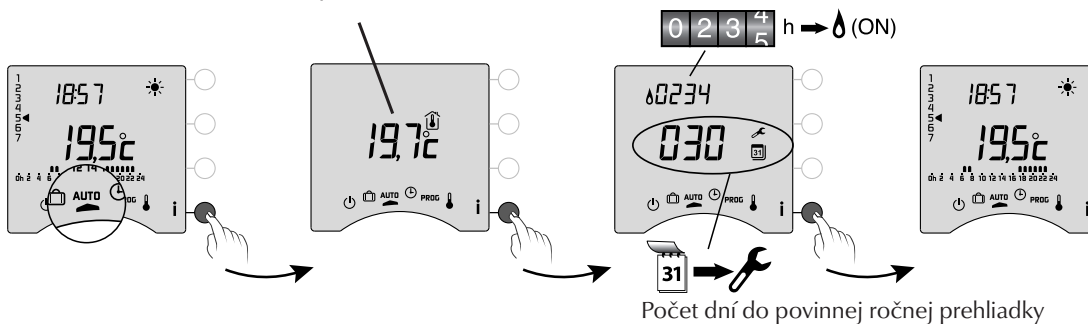



Nastavenie teplôt

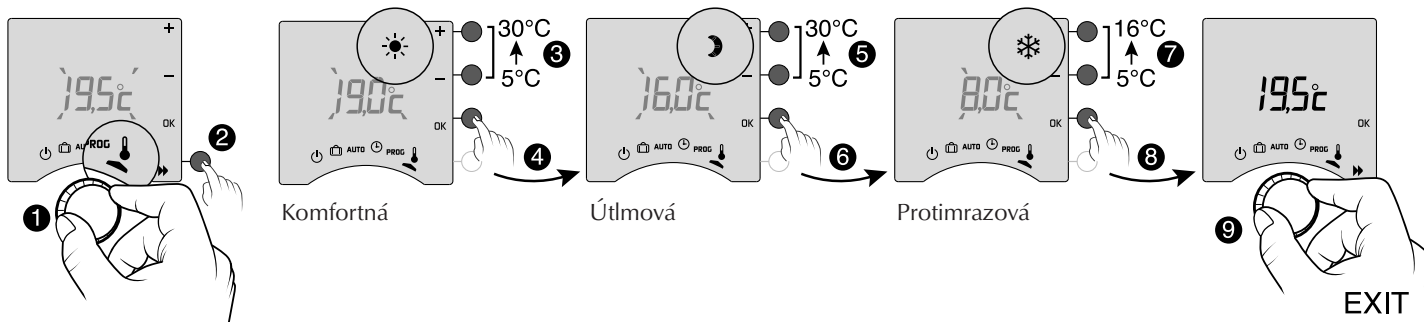

Manuálny režim

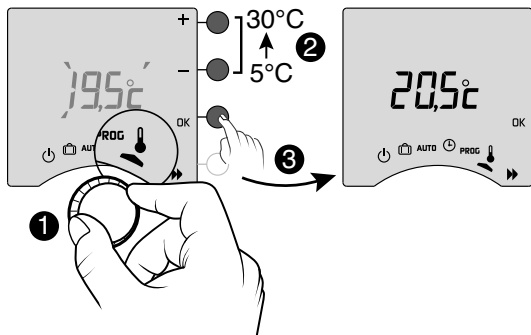

Tento mód slúži na nastavenie konštantnej teploty



Dočasná zmena režimu



V automatickom režime umožňujú táto funkcia prechod z režimu Komfort do Útlmového režimu (alebo naopak), až do ďalšej zmeny programu.

Napríklad: je 15:30 a chceme prepnúť na Komfort režim do naprogramovanej hodiny (17:00).

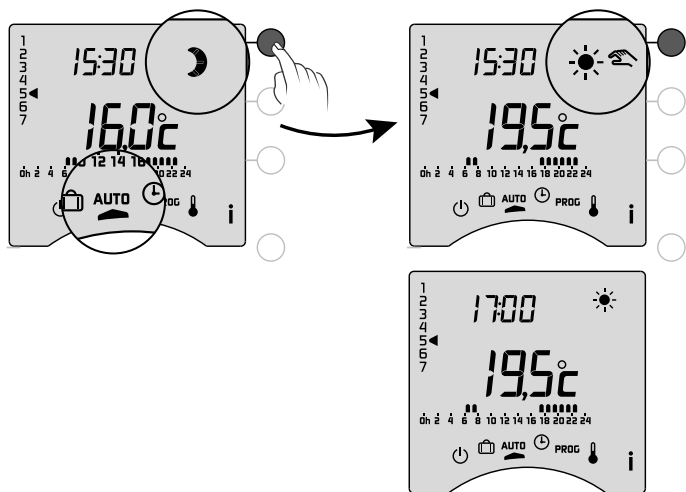

O 17:00 hod.
sa program vráti
k nastavenému
programu

PROG x 1



Například: Komfort od 6:00 do 8:00 a od 17:00 do 23:00

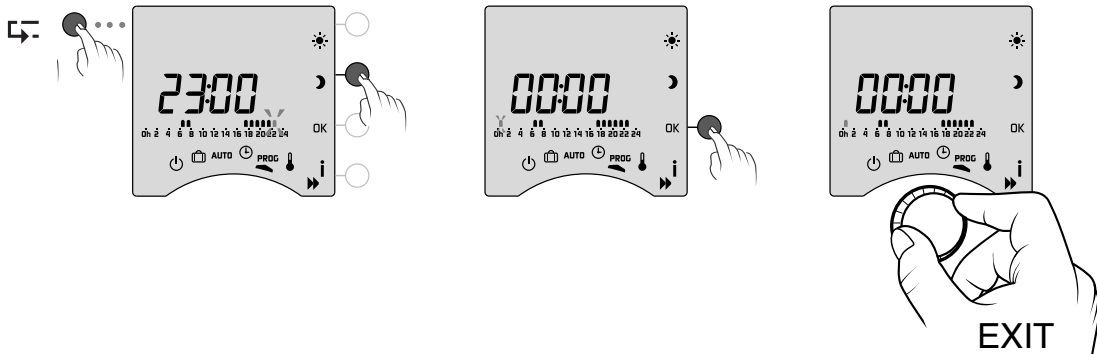
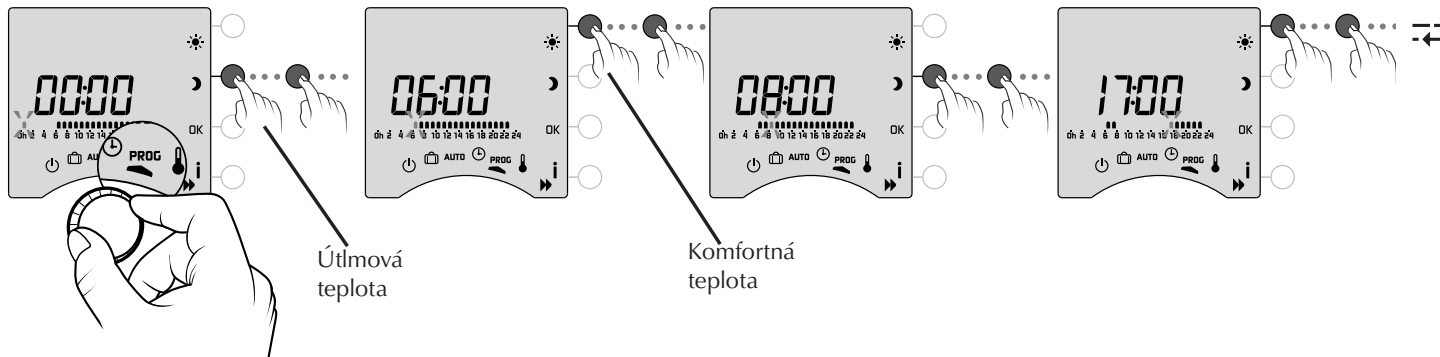

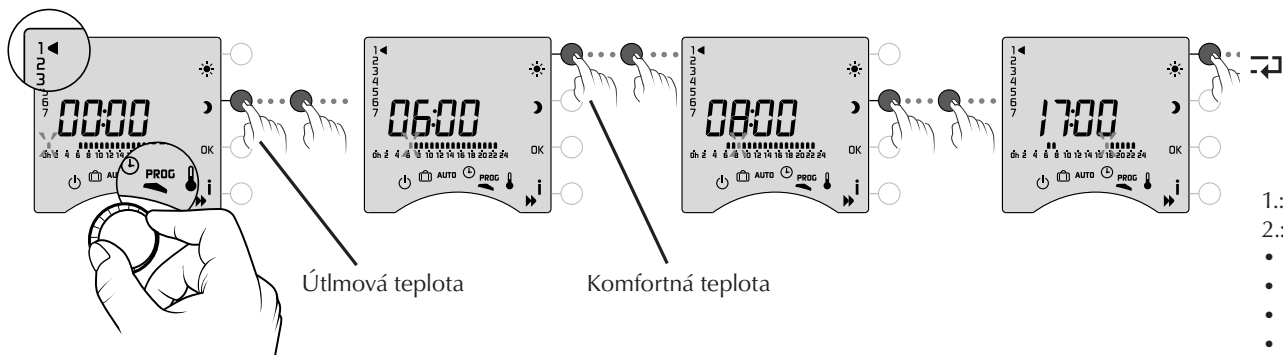

- 1.: Pondelok
 2.: Utorok
 .
 .
 .
 .
 7.: Nedeľa

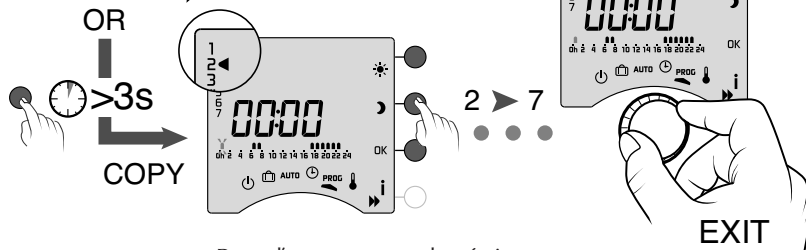
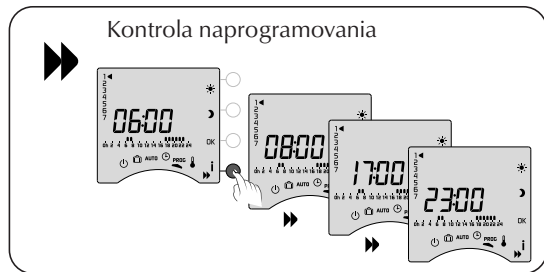
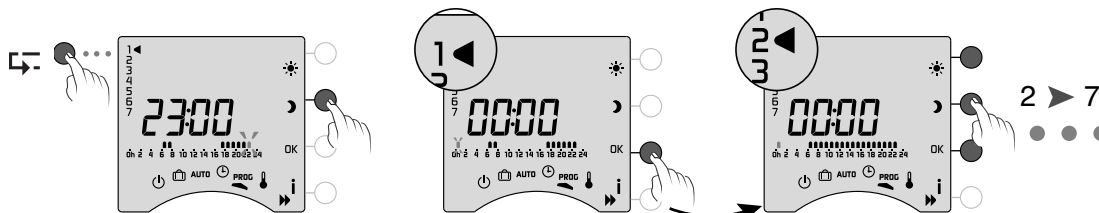

Potvrďte program a skopírujte do nasledujúceho dňa



Režim dovolenka

Například

Pi	10	
So	11	
Ne	12	
Po	13	
Ut	14	
St	15	
Št	16	
Pi	17	
So	18	
Ne	19	



Zvol' dátum návratu

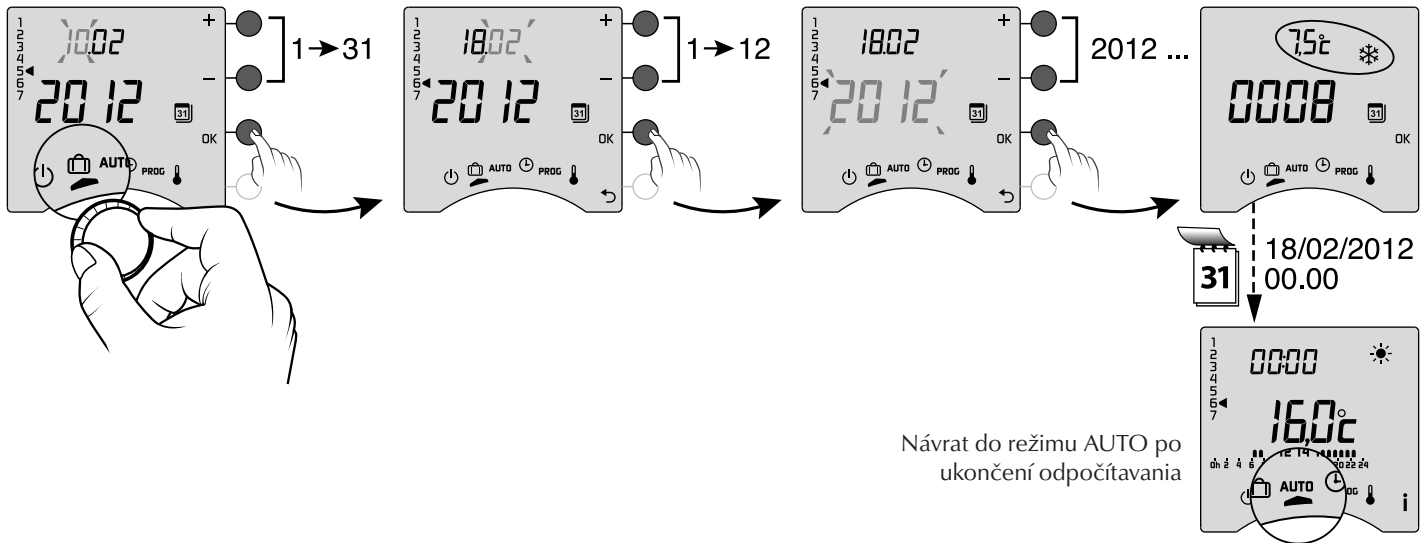

Návrat do režimu AUTO po ukončení odpočítavania



Vypnutie

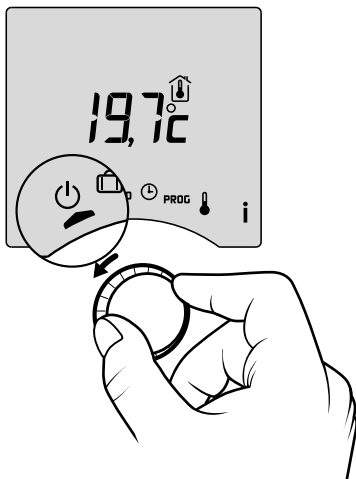

STOP



Výmena batérií

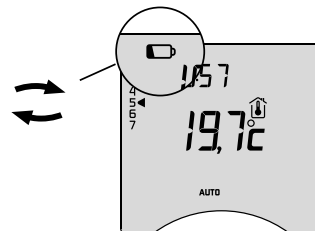

Alkaline 1,5V
LR03 (AAA)

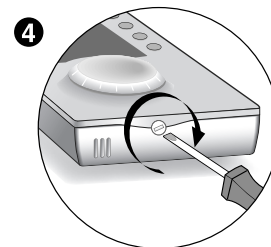
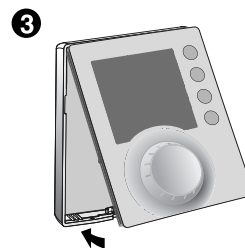
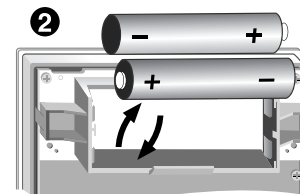
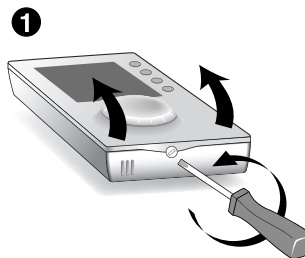

TYBOX 137

Návod na montáž

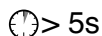

 > 5s



PROG
x1

PROG
x7

Stlačte tlačítko na min. 5 sekúnd

Spárovanie zariadení

Pomalé blikanie LED

LED nesvieti









Teplota v miestnosti

Teplota nastavená užívateľom

Denné programovanie

Týždenné programovanie

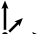

	2 x 1,5V LR03 - AAA Alkaline	230V~, 50 Hz +/- 10% 0,5 VA
		
	868 MHz (EN 300 220) 100 m	
	8 max.	
	/	5 A max., 230V~ (Type 1.C)
°C	-5°C / +40°C	
	80 x 103 x 25 mm	54 x 102 x 20 mm
		IP 30
	R&TTE 1999/5/CE	

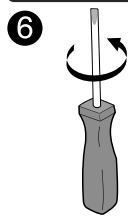
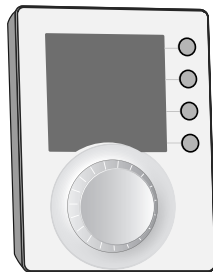
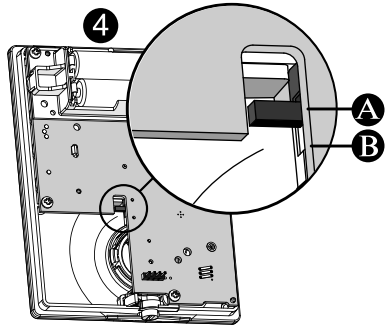
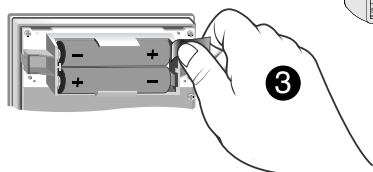
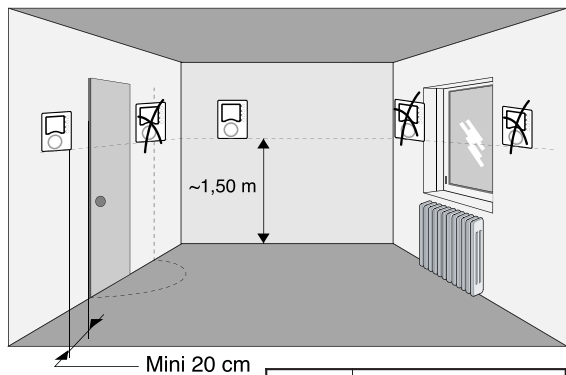
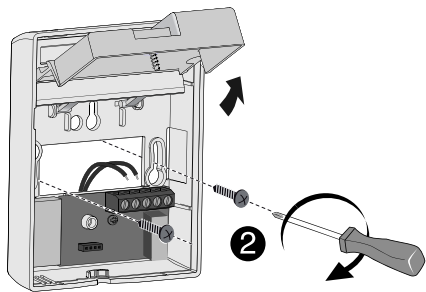
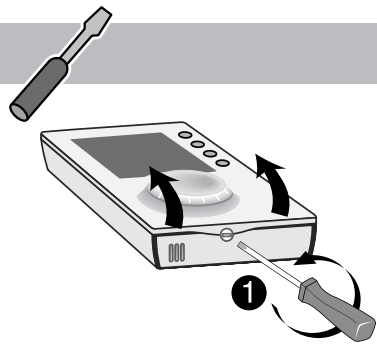

A	PROG x7
B	PROG x1

2A 230 V~

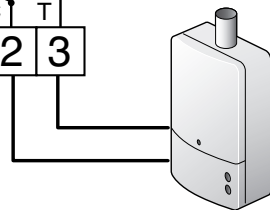
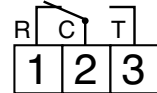

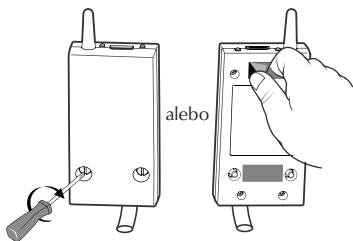
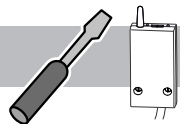

alebo

- 1 Modrá
- 2 Hnedá
- 3 Čierna
- 4 Šedá

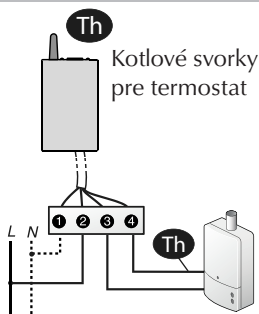
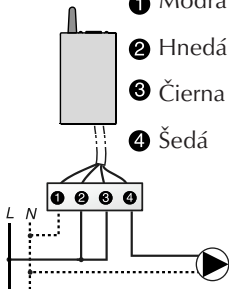

Kotlové svorky pre termostat

Možnosť zmeny polohy spínacieho kontaktu

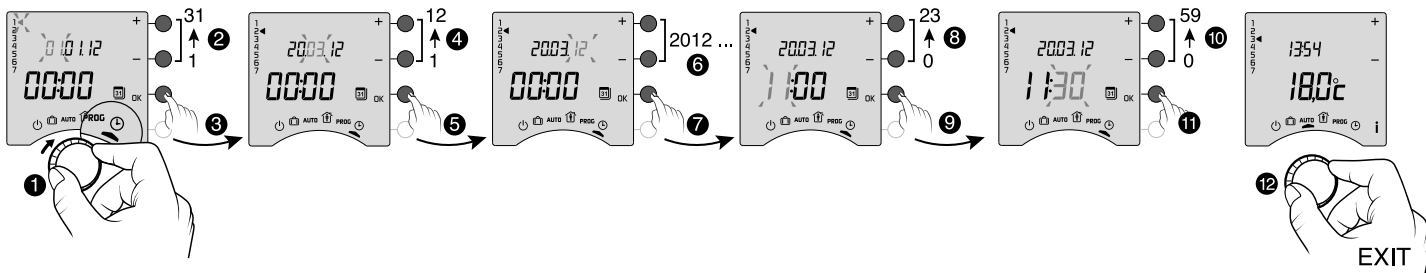
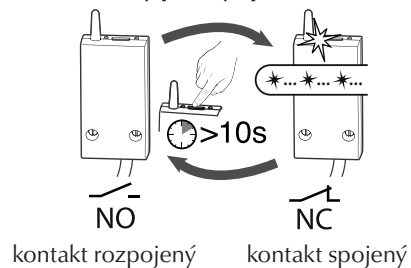

Výmena batérií

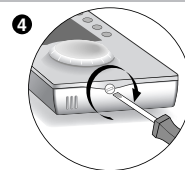
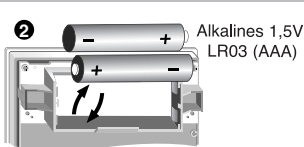
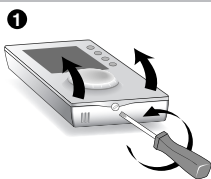
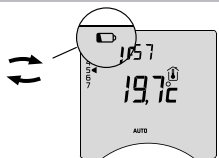



MENU 1

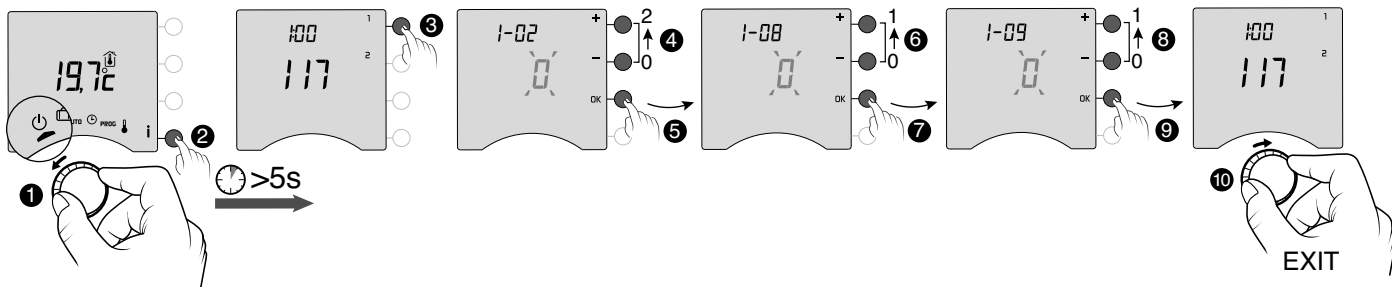

<p>1-02</p> <p>Skok pri programovaní</p>	<p>60', 30', 15'</p>
	<p>0 60 min.</p>
	<p>1 30 min.</p>
	<p>2 15 min.</p>

<p>1-08</p> <p>Regulácia teploty Komfort</p>	<p>0 Teplota Komfort riadená termostatom TYBOX (výrobné nastavenie)</p>
	<p>1 Teplota Komfort je riadená iba termostatickými hlavicami. Displej zobrazuje ConF a TYBOX riadi iba teploty a .</p>

<p>1-09</p> <p>Systém na predchádzanie blokovania obehového čerpadla</p>	<p>0 Systém nie je aktívny (výrobné nastavenie)</p>
	<p>1 Systém je aktívny (spustenie obehového čerpadla na 1 minútu, každých 24 hodín)</p>



MENU 2

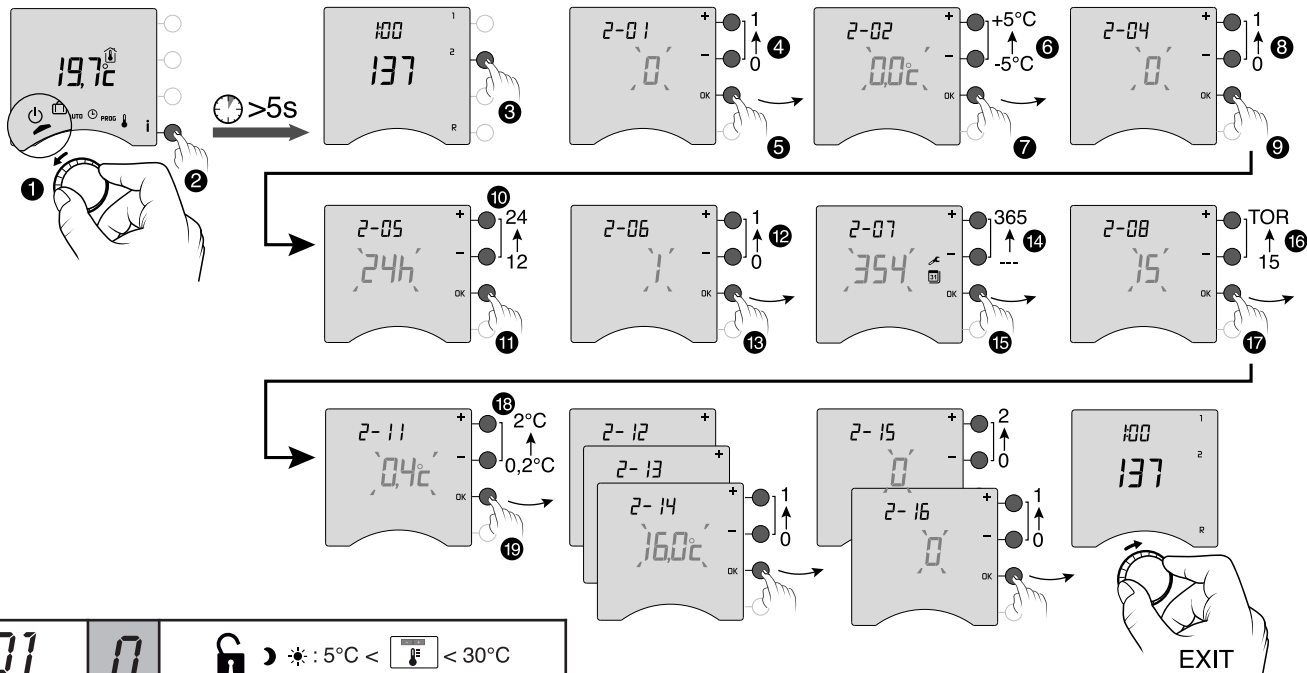

2-01	0	: 5°C < < 30°C : 5°C < < 16°C
	1	+/- 3°C
		PROG

2-02	-5°C < < +5°C
Korekcia nameranej teploty	



MENU 2 - pokračovanie

2-04	0	
Teplota zobrazená v AUTO režime	1	

2-05	24 h
Voľba režimu 12 alebo 24 hod.	12 h

2-06	0	
Automatická zmena času	1	

2-07	
Upozornenie na ročnú prehliadku	--- (0) až 365 dní

Preprogramujte po vykonaní ročnej prehliadky.

2-08	15	minút (odporučené)
Čas kontrolných cyklov regulačného systému	30	minút
	45	minút
	60	minút
	tor	ON/OFF termostat



2-11	0,2°C < Hysterézia < 2°C
2-08 = tor	0,4°C

2-17	0	NIE
Vynulovať počítadlo hodín prevádzky kotla	1	ÁNO



RESET - návrat k výrobnému nastavení

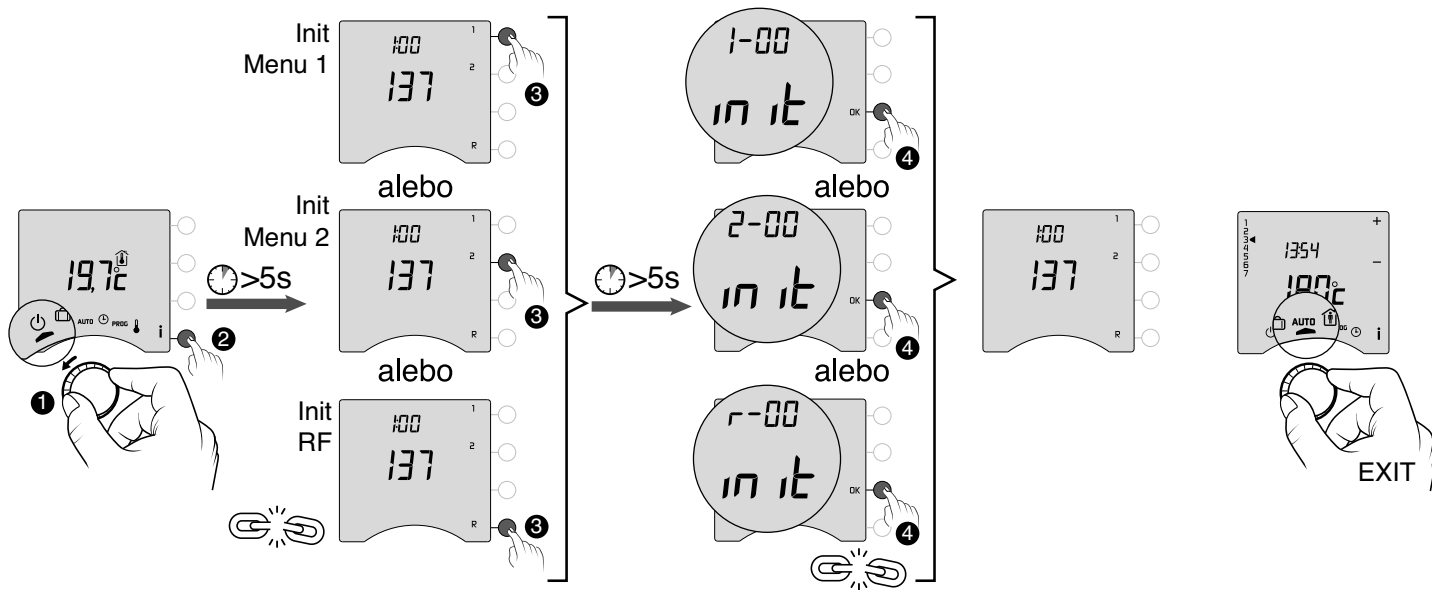



Výrobky sú dodávané spárované.

Ak chcete znovu pripojiť termostat (po resete), postupujte ako je znázornené nižšie:

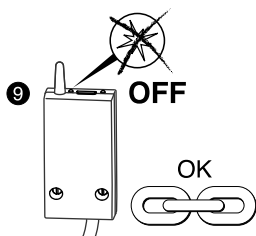
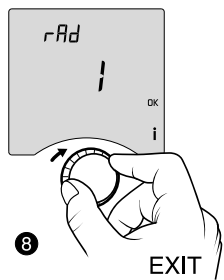
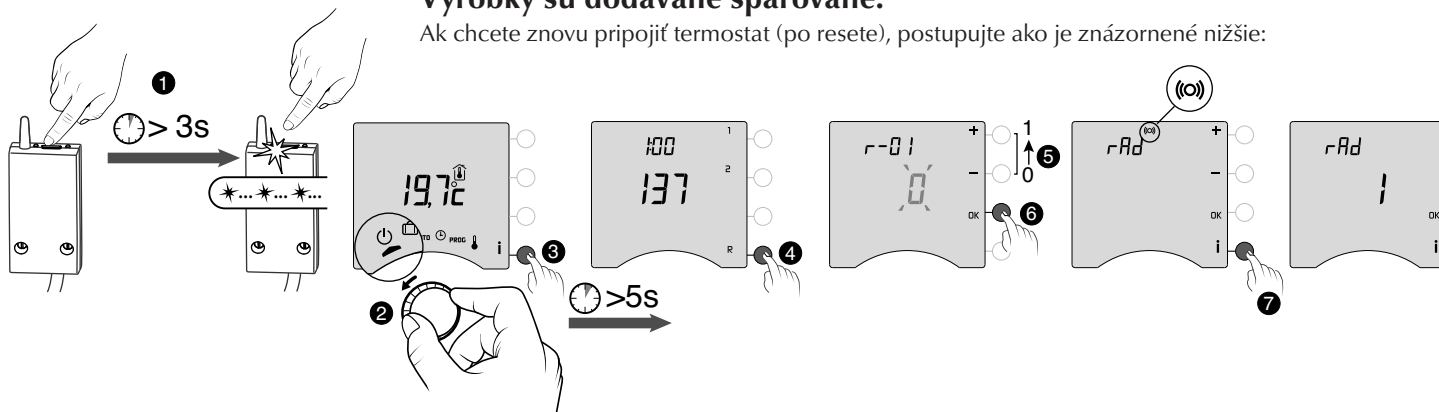

R-01 spárovanie zariadenia	0	Nespárované
	!	Spárované